

120/120 Plus

Digital Weight Indicator

Specifications

Power:

120/120 Plus:

Line voltages: 230VAC

Frequency: 50 or 60 Hz

120 Plus: (estimated battery life)

60 hours with 1 x 350 Ω

40 hours with 4 x 350 Ω

Charge time eight hours

Excitation Voltage:

5VDC, 4 x 350 Ω or 8 x 700 Ω load cells

Analog Signal Input Range:

-0,6 mV/V - 3,0 mV/V

Analog Signal Sensitivity:

0,3 μV/graduation minimum, 1,5 μV/grad recommended

Resolution:

Internal resolution: 1 million internal graduations

Display resolution: 10.000 displayed graduations

Measurement Rate:

120: 30, 15, 7, 3 per second

120 Plus: 30 per second

System Linearity:

Within 0,01% of full scale

Circuit Protection:

RFI, EMI, ESD protected

Load Cell Connection:

Cord grip entry

Detachable plug (optional)

Serial Output:

EDP port: Full duplex RS-232

Printer port: Output-only RS-232 or active 20 mA current loop

Both ports: 9600, 4800, 2400, 1200, 600, 300 bps; seven or eight data bits; even, odd or no parity

Display:

120:

20 mm, six-digit red Light Emitting Diode (LED) display, seven segment digits

120 Plus:

20 mm six-digit LCD with backlight seven-segment digits

Status Annunciators:

Designators for: center of zero, stand still, gross, net, lb, kg, oz, g

120 Plus:

Battery, setpoint 1 and 2, hold

Keyboard:

120:

Five-key flat membrane panel, tactile feel

120 Plus:

Zero, tare, present tare, hold, gross/net, units, numeric 0-9, clear, enter/print

Digital I/O:

120 Plus: Requires option card

24 volt source

Three digital inputs

Two digital outputs

Operating Temperature:

Legal: -10° C to 40° C

Industrial: -10° C to 50° C

Weight:

1,2 kg

Rating/Material:

Enclosure: heavy gauge ABS

Warranty:

One-year limited warranty

Approvals:

OIML TC 7028, TC7628; T 5692 10.000 d

CE marked



Approvals



Standard Features

120

- Large 20 mm Light Emitting Diode (LED) Display
- Configurable analog to digital measurement rate
- Power for four 350 ohms load cells
- Primary/secondary units configuration: lb, kg, oz, g
- Five-button operation
- Two independent communication ports: (1) full duplex, (1) unidirectional or active 20 mA current loop
- Standardized EDP command sets
- Programmable ticket format up to two 180-character printout
- Full front-panel digital calibration and configuration
- Tilt stand
- Three-stage digital filtering
- Consecutive transaction numbering
- Time and date (volatile)

120 Plus

- Large 20 mm backlit LCD display
- Rechargeable battery and wall adapter
- Power save feature for 700 hours of battery life
- Ten stored tare values
- Display hold (based on 3 second average)
- Time and date

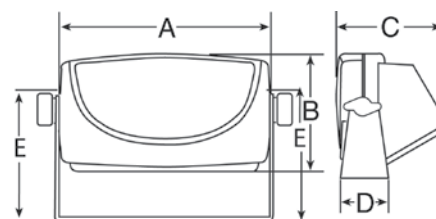

DIMENSIONS

A	183 mm	D	42 mm
B	154 mm	E	121 mm
C	95 mm		

120/120 Plus

Digital Weight Indicator

Part Numbers

PART #	DESCRIPTION	EST. SHIP WEIGHT
120		
131923**	Desktop 115VAC/230VAC	1,36 kg
120 Plus		
103632**	Desktop 115/230VAC	1,36 kg
107619**	Desktop 115/230VAC with digital I/O option	1,36 kg

Options/Accessories

PART #	DESCRIPTION
93205	Load cell connector with six meter length pigtail (requires 103507)
82505	6-Pin socket external load cell connector (requires 103507)
103507	External load cell plug replaces cord grip (requires 82505 or cable 93205)
107620	Digital I/O card for 120 Plus
105670	15-Pin connector for 120 Plus
106705	15-Pin interface cable for 120 Plus, 2 meter length
76699	Additional operating manual for 120
105914	Additional operating manual for 120 Plus
77925*	Revolution® scale software
Primary Component Parts for 120	
131924	Board assembly for use with internal LC connector
78610	Overlay membrane switch
131925**	Power supply, 115VAC/230VAC
Primary Component Parts for 120 Plus	
103634	CPU/display board assembly
103635	Overlay membrane switch
103636	Power supply, 115VAC/230VAC
103637	Rechargeable battery

*Revolution can be downloaded for FREE at www.ricelake.eu



CEE 7/7 plug

**Both plugs included with power adapter